

- NOTE:**
- TCP developed in accordance with TCAWS TCP 54.
 - This TCP is in conjunction with:
 - TCP-SMP-CAS-SB-0403 (Pedestrian Mgt)
 - TCP-SMP-CAS-SB-0402 (VMS Strategy Plan)
 - Traffic Controllers to assist Traffic & Pedestrians during works.
 - Lighting to be provided where adequate street lighting is not available.

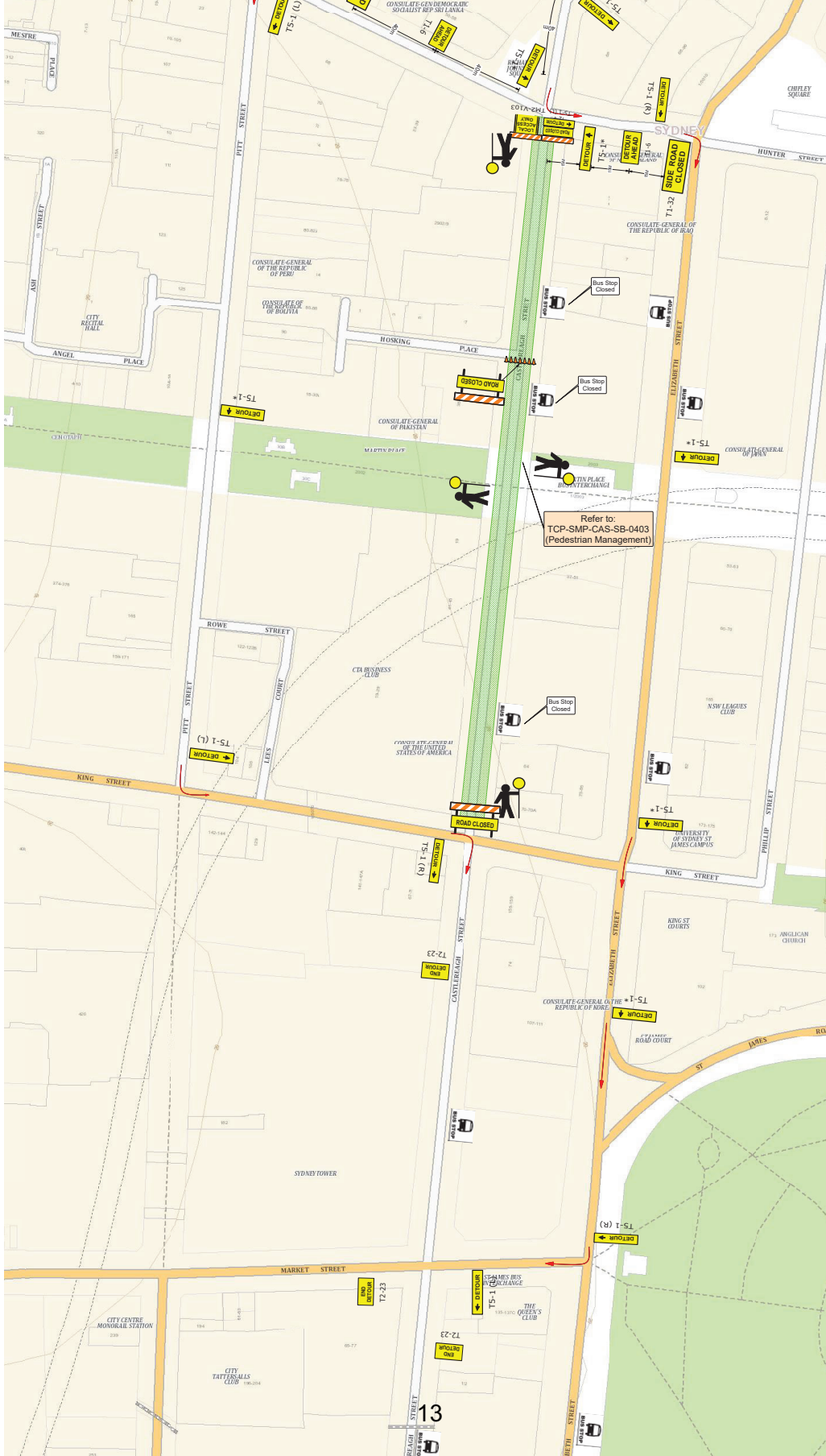

Castlereagh Street Full Road Closure



 <p>TRAFFIC CONTROL PLAN</p> <p>DATE: 10/09/2018 REV 1: 25/07/2019</p>	<p>*Australian Standards AS 1742.1</p> <p>*Traffic Control at Workplaces Manual</p> <p>*Principal's General Specifications G10 - Traffic and Transport Management</p> <p>*Relevant Australia's Guides</p> <p>*2005 Supplements to Australia's & Australian Standards</p> <p>*Sydney Metro Principal Contractor Health and Safety Standard</p>	<p>Area: Martin Place (SMP)</p> <p>Location: Castlereagh St, Sydney</p> <p>TCP No: TCP-SMP-CAS-SB-4403</p> <p>Sheet No: 1 OF 1</p>	<p>Install as per TCP and in accordance with any changes as shown on TCP</p> <p>Team Leader (Onsite): _____</p> <p>Signature: _____</p> <p>Date: _____</p> <p>Ticket: Orange/Red/Yellow (Circle Appropriate)</p> <p>Ticket No: _____</p> <p>Reasons for modification: _____</p> <p>Email to: NSW.SMD.TRAFFIC@SYDNEYMETRO2.COM.AU</p>	<p>DRAWN BY: SAMANTH JADALA</p> <p>CERTIFICATE NO: 0044399691</p> <p>SIGNATURE: _____</p> <p>PLAN CHECKED BY: ABDULLAH KHAN</p> <p>CERTIFICATE NO: 0032576588</p> <p>SIGNATURE: _____</p>
--	---	--	--	---

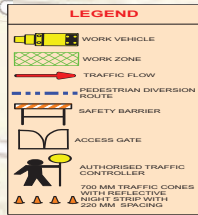

NOTE:

1. TCP developed in accordance with TCAWS TCP 54.
2. This TCP is in conjunction with
 - *TCP-SMP-CAS-SB-4402.
 - *TCP-SMP-CAS-SB-0403.
3. Lighting to be provided where adequate street lighting is not available.

GENERAL TRAFFIC DETOUR ROUTE

